



Chaucer Road, Farnborough

£375,000



Chaucer Road, Farnborough

Completely updated and renovated to a very high standard this 4 bedroom, 2 bathroom family home is perfectly situated within easy reach of local schools, playing fields and amenities. Excellent commuter links, out of town superstores, and Frimley Park Hospital all nearby.

FEATURES

- Residential parking
- Modernly decorated throughout
- Open plan kitchen and dining area
- Newly replumbed and rewired
- New kitchen, bathrooms, roof and windows
- Low maintenance garden
- Local amenities nearby
- 1.5 miles to Farnborough mainline station with trains direct to Waterloo in 36 mins & Guildford in 17 mins
- Easy reach of main roads, motorways, Heathrow & Gatwick
- Band B – Rushmoor Borough Council

ACCOMMODATION

- Entrance Hall
- Lounge
- Kitchen and dining area
- Cloakroom
- Master bedroom with en-suite
- Three further bedrooms
- Family bathroom

OUTSIDE

- Low maintenance garden area
- Rear gate access to road

EPC RATING

C





Chaucer Road, Farnborough, Hampshire, GU14

Approximate Area = 1084 sq ft / 100.7 sq m

Shed = 9 sq ft / 0.8 sq m

Total = 1093 sq ft / 101.5 sq m

For identification only - Not to scale

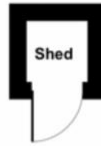

Disclaimer: We wish to inform prospective purchasers that we have prepared these sales particulars as a general guide. We have not carried out a detailed survey, nor tested the services, appliances and specific fittings. Room sizes are approximate and rounded: they are taken between internal wall surfaces and therefore include cupboards / shelves, etc. Accordingly, they should not be relied upon for carpeting, curtains / blinds and kitchen equipment, whether fitted or not, are deemed removable by the vendor unless specifically itemized within these.

Postcode for sat nav: **GU14 8SW**

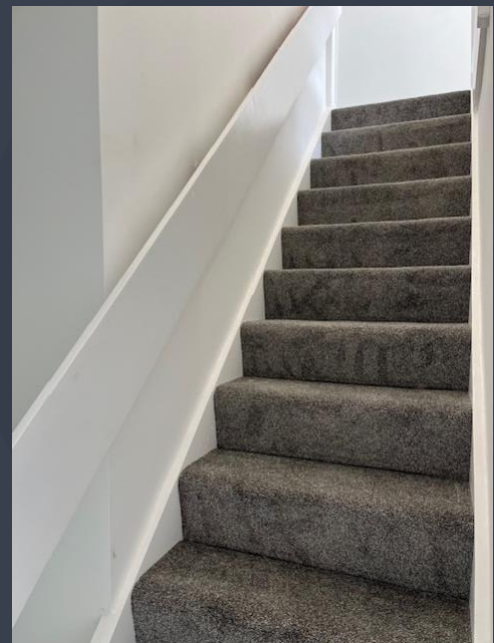

The Old Dairy, 7 Updown Hill, Windlesham, Surrey GU20 6AF
enquiries@newtonrowe.co.uk | 01276 986900